

Smart Automation and Monitoring System

UHF READ/WRITE HEAD WITH INTEGRATED IO-LINK PROCESSOR UNIT

Powerful, smart sensor technology and multifunctional solutions form the basis for increasing the efficiency and effectiveness of your machines and plants.

Thanks to their smart features, our intelligent components also provide you with valuable and uniform diagnostic data in addition to process and condition data. They open up new possibilities for you – from monitoring the condition of the machine and entire plants (condition monitoring) to predictive/preventive maintenance and completely new business models.

The Smart Automation and Monitoring System (SAMS) represents Balluff's comprehensive automation philosophy. Thanks to its standardized operating and configuration concept, long commissioning times, high training costs and unexpected device failure are also a thing of the past.

Part of the SAMS are our new UHF read/write heads with integrated IO-Link evaluation unit (860...960 MHz), which are used especially for identification in format part recognition.

These read/write heads are optimized for close range and reliably detect objects at reading distances of up to 50 cm. They impress with their IO-Link interface, which enables smooth integration by connecting to master network components in the SAMS. Their M30 compact cylinder housing can also be easily installed in confined spaces. In addition to reliable identification, the read/write heads provide you with numerous condition monitoring functions – such as temperature and signal quality monitoring – as well as other multifunctions.

Features

- Washdown Plus promise: Exceeds IP69K protection rating and 1000 cleaning cycles are guaranteed
- Hygienic material (stainless steel 1.4404/PBT)
- H2O2-resistant
- IO-Link interface with advanced smart features

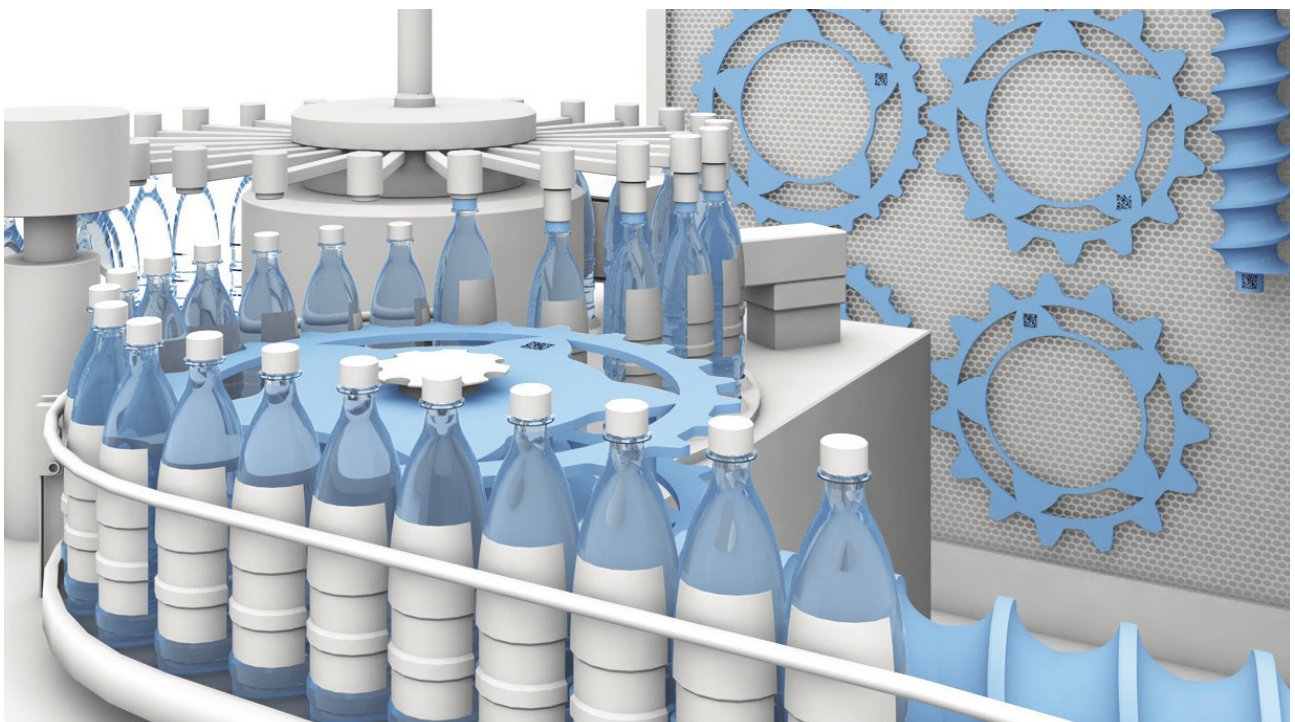

INDUSTRIAL RFID SYSTEMS



	BIS01E4	BIS01E8	BIS01E9
Working frequency	865.6...867.6 MHz	902...928 MHz	920.5...924.5 MHz
Radio approval	Europe	USA	China
Dimension	M30 × 98 mm	M30 × 98 mm	M30 × 98 mm
Antenna type	Patch	Patch	Patch
Polarization	Circular	Circular	Circular
Output power adjustable	-9.25...+13.75 dBmERP	-7...+16 dBmEIRP	-9.25...+13.75 dBmERP
Connection	M12 male, 4-pin, A-coded	M12 male, 4-pin, A-coded	M12 male, 4-pin, A-coded
Housing material	Stainless steel, PBT	Stainless steel, PBT	Stainless steel, PBT
Interface	IO-Link 1.1, COM 3	IO-Link 1.1, COM 3	IO-Link 1.1, COM 3
Process data IN/OUT	32/32 bytes	32/32 bytes	32/32 bytes
Operating voltage U _B	24 V DC LPS Class 2	24 V DC LPS Class 2	24 V DC LPS Class 2
Ambient temperature	0...+70 °C	0...+70 °C	0...+70 °C
IP rating	IP68/IP69K	IP68/IP69K	IP68/IP69K
Approval/conformity	CE, ETSI EN 302 208, cULus, EAC	FCC Part 15, IC RSS-210, cULus, EAC	CMIIT-Radio Transmiss. Equipm., cULus
Condition monitoring features	Vibration detection, inclination detection, internal temperature monitoring, voltage and current monitoring, signal quality check, extreme environment status, LED diagnostics		
Multi-functions	Operating hours counter, boot cycle counter, ping for visual localization of the device, Pin 2 for output of internal digital signals		

SUITABLE DATA CARRIERS

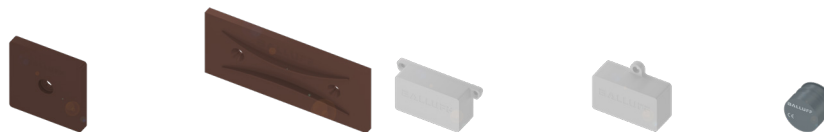

	BIS00WF	BIS00WC	BIS018F	BIS018H	BIS0178
Working frequency	860...960 MHz	860...960 MHz	860...960 MHz	860...960 MHz	902...928 MHz
Dimension	51.5 × 6.4 × 51.5 mm	52 × 11.5 × 128 mm	29.3 × 19.2 × 66.2 mm	38.1 × 19 × 51.3 mm	Ø 17.2 × 14 mm
Installation	Metal-free (clear zone)	Metal-free (clear zone)	Metal-free (clear zone)	Metal-free (clear zone)	On metal
Housing material	PPS	PPS	PVDF	PVDF	PA 12, GF30

CONNECTIVITY



	BCC0C8L	BCC0E3C	BCC0LY5	BCC0LYF
Application	Standard	Standard	Washdown	Washdown
Connector 1	M12 female, straight, 5-pin	M12 female, angled, 5-pin	M12 female, angled, 5-pin	M12 female, straight, 5-pin
Connector 2	M12 male, straight, 4-pin	M12 male, straight, 4-pin	M12 male, straight, 4-pin	M12 male, straight, 4-pin
Cable	PUR shielded black, drag-chain compatible	PUR shielded black, drag-chain compatible	PVC with stainless steel union nut, shielded	PVC with stainless steel union nut, shielded